



## 2N® LTE Verso

2N® LTE Verso combines minimum installation costs with a full feature set. Using LTE technology means no other cable apart from a power supply is needed, with a benefit of all advanced functionalities such as a video communication. The main unit with HD camera can be accompanied by RFID, Bluetooth or biometrics supporting modules.



Villas  
Small office-home office

Family houses  
Office building

### Ideal retrofit solution

Thanks to LTE connection 2N® LTE Verso is not depending on available wiring and answering units. Together with 2N® Mobile Video service it offers full range of features like video calls to mobile devices and 2N answering units just like wired intercom.

### Secure configuration via cloud

Connect 2N® LTE Verso to the LTE network and then use 2N® Mobile Video service on My2N.com to configure all its features from anywhere in the world via secured VPN connection.

### Pick any of the 14 modules available

2N® LTE Verso is using a standard BUS and therefore it can be connected to any of the additional modules, e.g. RFID, Bluetooth or biometrics. Choose a module with technology that suits you the most.

# 2N® LTE Verso

## FEATURES & BENEFITS

### MINIMUM INSTALLATION COSTS

The LTE intercom doesn't need any cables and therefore it's an ideal solution for retrofit in older buildings where addition wiring installation would be uneconomical.

### MODULARITY

The modularity of this IP intercom allows you to configure it to your requirements. Select the specific module, accessories and configurable functions.

### MOBILE CREDENTIALS ARE FOR FREE

Unlike our competitors, 2N offers mobile credentials via Bluetooth for free. Don't pay 6-10USD per each credential or any other fees. Simply install 2N® Mobile Key app and start to use your phone to open the door!

### CALLS TO MOBILE PHONE AND TABLET

2N® LTE Verso allows you to call a mobile phone or tablet over the cellular data in case, that even these mobile devices are connected to the Internet.

### CAMERA WITH NIGHT VISION

See who is standing in front of your door, even in total darkness. Moreover, the camera is hidden from normal view. The intruder has no clue they're being monitored.

### SIP SUPPORT WITH NO SERVER NEEDED

SIP protocol support makes it easy to link the intercom with IP phones and PBX from other producers, without having to connect to the server.

### PICTURE TO EMAIL

2N® LTE Verso allows you to email snapshots of the visitor captured by the camera at the time of the call..

### ACCESS CONTROL

Achieve a greater level of security for all those at its location. 2N® LTE Verso makes it easy to prevent the entry of unauthorized persons.

## DIAGRAM

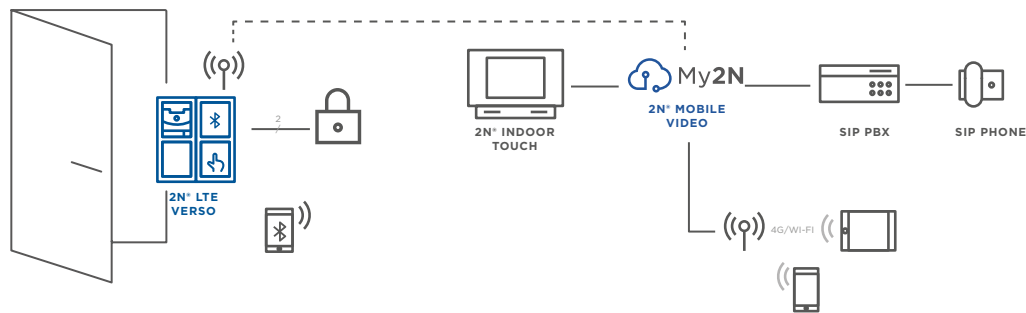

## TECHNICAL PARAMETERS

### Signalling protocol

SIP 2.0 (RFC - 3261)

### Buttons

Buttons	Transparent buttons with white backlight and easily removable label
Number of buttons	1 to 146
Numeric keypad	Optional

### Audio

Microphone	1 built-in microphone
Speaker	2W
Sound pressure at 1 kHz at 1 m distance	78 dB

### Audio stream

Codecs	G.711, G.729, G.722, L16/16kHz
--------	--------------------------------

### Camera

Resolution - JPEG	1280 x 960 px
Resolution - video call	640 x 480 px
Viewing angle	120° (H), 90° (V), 145° (D)
Night vision	Yes

### Video stream

Codecs	H.263+, H.263, H.264, MJPEG, MPEG-4
--------	-------------------------------------

### Interfaces

Power supply	12V ± 15%/ 2A DC
Network connection	LTE FDD Cat.1, 3GPP release 9 compliant 4G Bands (MHz): B1(2100), B3(1800), B7(2600), B8(900), B20(800) Output power - Class 3 (0.2 W, 23 dBm) @ LTE
Switch output	NC/NO contacts, max 30 V/1 A AC/DC
Connection speed	Uplink up to 5 Mbps Downlink up to 10 Mbps
Active switch output	8 to 12 V DC depending on power supply (source voltage minus 2 V), max 400mA

### Mechanical properties

Operating temperature	-40°C - 60°C, touch display -20°C - 60°C
Storage temperature	-40°C - 70°C
Operating relative humidity	10%-95% (non-condensing)
Coverage level	IP 54, IK08, touch display IK07

### Dimensions

Dimensions depend on configuration of the modules and installation type - see [www.2n.cz](http://www.2n.cz) for details.

## SOFTWARE

**2N® Mobile Key** - an application that turns your mobile phone into an access card

**2N® Mobile Video** - mobile application providing video calls from the intercom to your mobile device

# Modularity

MODULARITY CLARIFIED

2N® LTE Verso can be tailored to your requirements. Select the specific modules, frame and mounting box.

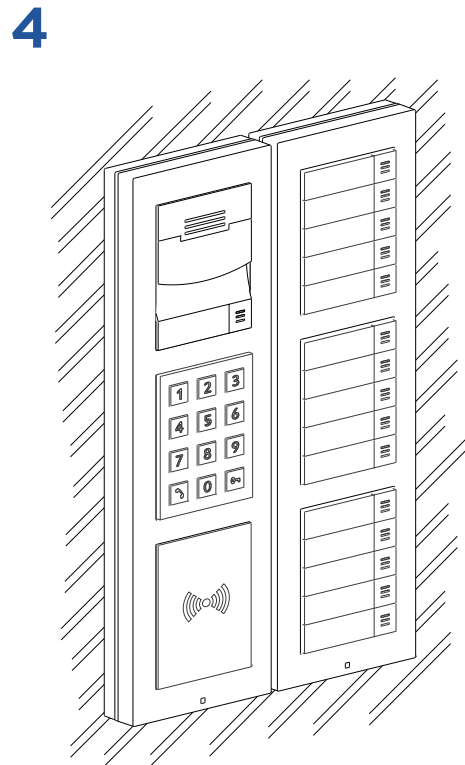
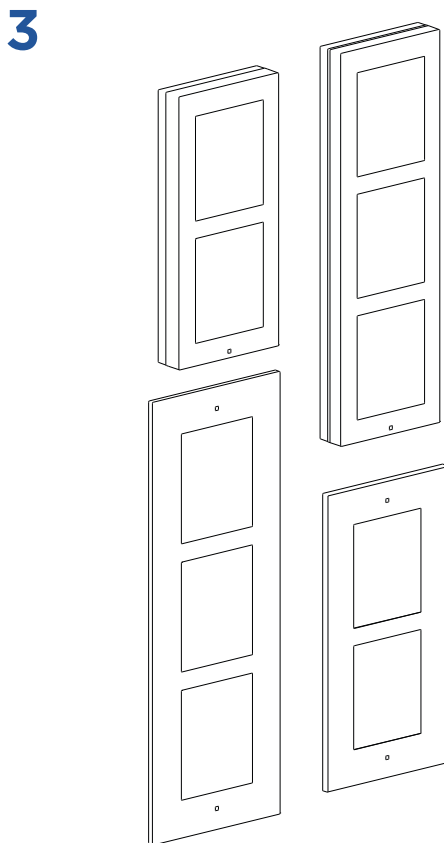
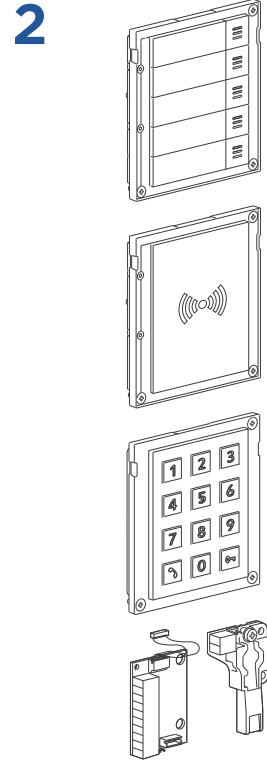
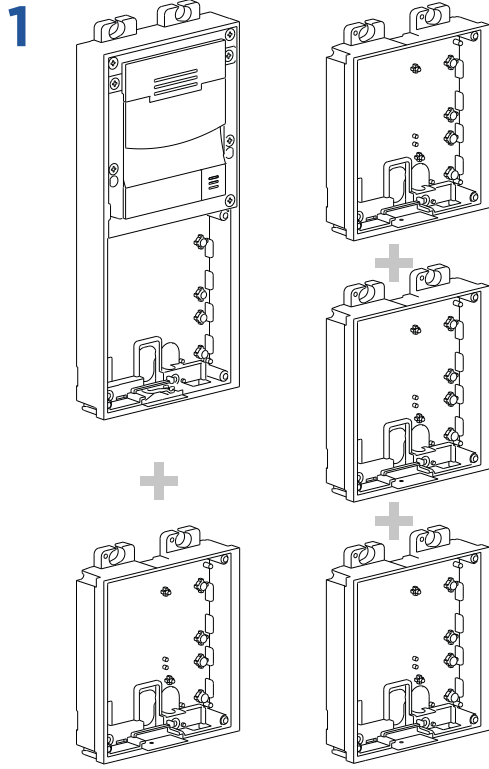

# Modularity

## MODULES

<p>Main unit with camera and internal LTE*</p> <p>9155401CB-E 9155401C-E</p>	<p>Infopanel</p> <p>9155030</p>	<p>5 buttons</p> <p>9155035</p>	<p>Touch Keypad &amp; RFID Reader 125 kHz, 13.56 MHz, NFC</p> <p>9155081 9155083 (secure)</p>	<p>Bluetooth &amp; RFID Reader 125 kHz, 13.56 MHz, NFC</p> <p>9155082 9155082 (secure)</p>	
<p>RFID card reader 13,56 MHz 125 kHz</p> <p>9155033 9155032</p>	<p>RFID card reader 13,56 MHz NFC</p> <p>91550942 9155042 (secure)</p>	<p>Fingerprint reader</p> <p>9155045</p>	<p>Keypad</p> <p>9155031B 9155031</p>	<p>Bluetooth Reader</p> <p>9155046</p>	<p>Touchscreen</p> <p>9155036</p>
<p>Touch Keypad</p> <p>9155047</p>	<p>Induction loop</p> <p>9155041</p>	<p>Blind Panel</p> <p>9155039</p>	<p>Wiegand</p> <p>9155037</p>	<p>Tamper switch</p> <p>9155038</p>	<p>I/O</p> <p>9155034</p>

## FRAMES

<p>Flush installation 1 module</p> <p>9155011B 9155011</p>	<p>Flush installation 2 modules</p> <p>9155012B 9155012</p>	<p>Flush installation 3 modules</p> <p>9155013B 9155013</p>	<p>Surface installation 1 module</p> <p>9155021B 9155021</p>	<p>Surface installation 2 modules</p> <p>9155022B 9155022</p>	<p>Surface installation 3 modules</p> <p>9155023B 9155023</p>

● Black version  
● Nickel version

## ACCESSORIES

<b>Boxes</b>	
Flush-mounting box for 1 module	9155014
Flush-mounting box for 2 modules	9155015
Flush-mounting box for 3 modules	9155016
<b>Other</b>	
Extension cable - 1 m long	9155050
Blind button	9155051
Nametag foil	9155052

<b>Backplates</b>	
Backplate - 1 module	9155061
Backplate - 2 modules	9155062
Backplate - 3 modules	9155063
Backplate - 2(w) x 2(h) modules	9155064
Backplate - 3(w) x 2(h) modules	9155065
Backplate - 2(w) x 3(h) modules	9155066
Backplate - 3(w) x 3(h) modules	9155067

<b>External antenna</b>	
External LTE antenna	9155048